

COLORATO

www.colorato.net

INSTRUCTION MANUAL OF GAS PATIO HEATER



For outdoor use only

Uses propane, butane or LPG only

Diameter of mesh guard: Ø360 mm

Total height: 1360 mm

Gas regulator: 28-30 mbar (for Greece)

Max. power: 12 kW

Heating area: 2 ~ 5 m²

MODEL: CLPH-13BPS



Read these instructions before the installation and use!

Retain the instructions for future reference!

These instructions are valid only if the country symbol appears on the instruction manual and the appliance.

TABLE OF CONTENTS	SEE ON PAGE
Caution	3, 4
Appliance stand and location	5
Gas requirements	5
Leakage test	6
Operation	6
Storage	7
Cleaning and care	7
Connecting gas line to LPG Gas Cylinder	7
Assembly	8
Specifications	9
Assembly parts	9
Problems check list	10

Notice: this appliance is adjusted to work with gases C30/ G31 (Butane/Propane) or mix of them, at 28-30/37/50 mbar. Do not use other type of gases!

CAUTION

PLEASE READ CAREFULLY THE FOLLOWING SAFETY GUIDELINES BEFORE OPERATION

- The use of this appliance in enclosed areas can be dangerous and is **PROHIBITED**.
 - The appliance must be installed in accordance with the instructions and National Rules in force.
 - Do not store or use gasoline or other flammable vapors or liquids into the appliance unit.
 - Installation and repair should be done by a qualified service person only.
 - This appliance must be installed according to National rules in force and the LPG Gas Cylinder, stored in LPG Gas Cylinder housing, should be of proper shape and in accordance with National Rules as above.
 - Improper installation, adjustment and alteration, can cause personal injury or property damage.
 - Do not attempt to alter the unit in any manner, it is very dangerous.
 - The gas governor and flexible rubber pipe must be according to National Rules in force and changed within the prescribed intervals, of each component.
 - Use only the type of gases and the LPG Gas Cylinder specified by the manufacturer (Butane, Propane or mix of them and specified supply pressure reported on point "B – Specification").
 - In case of violent wind particular attention must be taken against tilting of the appliance.
 - Check that the gas governor seal is fitted and that it is in good condition.
 - All leak tests should be done with a soap solution. Never use an open flame to check for leaks!
 - The whole gas circuit, flexible rubber pipe, gas governor, pilot and burner, should be inspected for leaks or damage before use and at least one time a month.
 - Do not use the appliance until all connections have been leak tested.
 - Do not paint the radiant screen, control panel or top canopy reflector.
 - Turn off the gas tap immediately, if smell of gas is detected.
 - Do not obstruct the ventilation holes of the LPG Gas Cylinder housing.
 - Never transport or move the appliance while it is operating.
 - Close the valve of the LPG Gas Cylinder, or gas governor one if any, all the time after use.
 - Shut off the valve at the LPG Gas Cylinder or the gas governor before moving the appliance.
 - Do not move the appliance after it has been turned off until the temperature has cooled down.
 - Control compartment, burner and circulation air passageways of the appliance must be kept clean.
 - Frequent cleaning may be required as necessary.
 - The LPG Gas Cylinder valve should be turned off when the heater is not in use.
- The gas governor/flexible rubber pipe assembly must be located out of pathways where people may trip over it or in area where the flexible rubber pipe will not be subjected to accidental damage.
- Any guard or other protective device removed for servicing the heater must be replaced before operating the appliance.
 - Adults and children should stay away from high temperature surface to avoid burns or clothing ignition.

-
- Children should be carefully supervised when they are in the area of the appliance.

Clothing or other flammable materials should not be hung on the appliance or placed on or near the appliance.



Attention!
Surface very hot.
Do not touch!!!!

- Keep the ventilation opening of the LPG Gas Cylinder housing free and clear of debris.
- Do not obstruct the ventilation holes of the LPG Gas Cylinder housing.
- For use outdoors and in well ventilated areas.
- A well ventilated area must have a minimum of 25% of the surface open area.
- The surface area is sum of the walls surface.

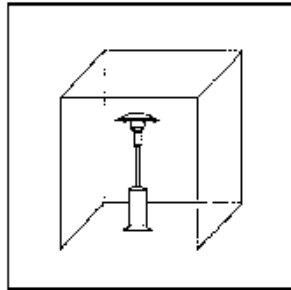

In case of violent wind particular attention must be taken against tilting of the appliance.

- Turn off the appliance immediately if any of the following occurs:
 - 1 - The appliance does not reach temperature.
 - 2 - The burner makes popping noise during use (a slight noise is normal when the burner is extinguished).
- Smell of gas in conjunction with extreme yellow tipping of the burner flames.
- Keep the instructions for future references.

WARNING: Improper installation, adjustment, alteration, service or maintenance can cause injury or property damage. Read the installation, operating and maintenance instructions thoroughly before installing or servicing this appliance. If the user cannot read or fully understand the instruction manual, please contact your dealer. Supplier will not be responsible for user's negligence.

APPLIANCE STAND AND LOCATION

The appliance is for outdoor use only. Do not use it for indoor or in an enclosed area. Always ensure that adequate fresh air ventilation is provided.

- Always maintain proper clearance from combustible materials, i.e. top 1000 mm and sides 500 mm minimum.
- Never operate appliance in an explosive atmosphere where gasoline or other flammable liquids or vapors are stored.

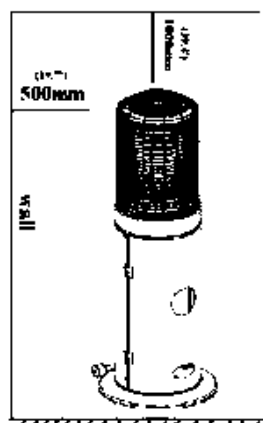

Warning: "Be carefully, accessibly parts may be very hot, Keep away from young children" when you see

GAS REQUIREMENTS

- The gas governor, flexible gas rubber pipe and clamps, are not supplied with this appliance; buy them according to National Rules in force and replace both taking into consideration expirc date, warnings of this Instruction Manual and National Rules in force.
- Supply pressures to appliance:
 - ✧ Nominal inlet pressure is 28-30/37/50 mbar
 - ✧ Min inlet pressure: 20 mbar
 - ✧ Max inlet pressure is: 50 mbar
- Gases to be supply: Butane, Propane or mixture of them
- Use gas governor approved according to Standard EN 12864, according to National Rules in force; make sure it is in good condition and substitute it not over 10 years, as properly.
- Check the flexible gas rubber pipe and other gas connections, at least once per month and each time the LPG Gas Cylinder is changed. If it shows signs of cracking, splitting or other deterioration, it shall be exchanged with a new flexible gas rubber pipe according to National Rules in force of same length (but not over 1,5 m) and of the equivalent quality.
- The installation must be done according to National Rules in force.
- A dented, rusted or damaged LPG Gas Cylinder, maybe hazardous and should be checked by your LPG Gas Cylinder supplier. Never use a LPG Gas Cylinder with a damaged valve connection.
- The LPG Gas Cylinder must be arranged to provide for vapor withdrawal from the operating cylinder.
- Never connect a LPG Gas Cylinder without a gas governor, to the appliance.
- Disconnect the LPG Gas Cylinder when the appliance is not use.

LEAKAGE TEST

Gas connections on the appliance are leak tested at the factory prior to shipment. Possible mishandling of the appliance during the shipment might contribute to product integrity as a whole. A complete gas leakage test must be performed again at the installation site. Please follow the procedure below for leakage test.

- Make a soap solution of one part liquid detergent and one part water. The soap solution can be applied with spray bottle, brush or rag. Soap bubbles will appear where a leak is present.
- Make sure the control tap is in the "OFF" position on the control panel.
- Turn on the gas supply and check for bubbles from the hoses and connections. Presence of bubble means that a leak path is present.
- If a leak is present, turn OFF the gas supply immediately, tighten any leaking fitting carefully, turn gas again and recheck.
- Never leak test while smoking.

OPERATION

TO TURN ON THE HEATER

1. Turn on the valve on the gas supply cylinder.
2. Press and turn the variable control knob to the HI position.
3. Press down the variable control knob and hold for 30 seconds. While holding down the variable control knob, press the igniter button several times until the burner head flame ignites. Release the variable control knob 10 seconds after the ignition.

- If a new tank has just been connected, please allow at least one minute or more for the air in the gas pipeline to purge out through the pilot hole, or simply do step 3.
- When lighting the flame make sure that the variable control knob is continuously depressed while pressing the igniter button. Variable control knob can be released after flame lit for 10 seconds.
- The flame can be watched and checked from the peephole located on the base of the burner.

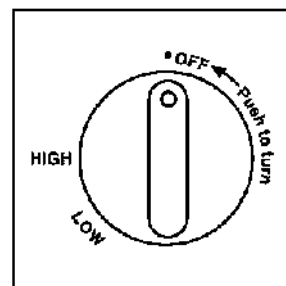

- If need small flame, turn the variable control knob to LO position.
4. Turn the variable control knob to LO position for 5 minutes or more before turning the knob to desired temperature setting.
 5. If the burner flame goes out accidentally or its blown out by wind, turn off the heater and wait at least 5 minutes or more to let the gas dissipate before lighting again to avoid possible gas explosion. Repeat steps 2 to 4.
 6. Failure to follow this ignition procedure may result in flame roll out beyond the emitter grid.

TO TURN OFF THE HEATER.

Press and turn the control knob to OFF position.

Turn off the valve on the gas cylinder and disconnect the cylinder.

STORAGE

- Always close the gas valve of the LPG Gas Cylinder, after use or in case of a disturbance.
- Remove the pressure controller and the hose.
- Check the tightness of the gas valve and for damage. If you suspect damage, have it changed by your gas dealer.
- Never store LPG Gas Cylinder in a sub-terrain, or at places without adequate air ventilation.

CLEANING AND CARE

- Wipe off exterior surfaces with soft, moist rag and soap water. Do not clean heater with cleaners that are combustible or corrosive.
- Remove debris, spider and insect nests from ventilation opening of the LPG Gas Cylinder enclose, control compartment, burner and circulation air passageways of the appliance with heavy-duty pipe cleaner or compressed air to keep appliance clean and safe for use. Never clear ports or other openings with toothpicks or other article that will break and block the ports.
- Do not paint the flame screen, control panel or reflector.
- Cover the burner unit with the supplied protective cover when the heater is not in use. Wait until the appliance is cool before covering.
- In a salt-air environment, such as near an ocean, corrosion occurs more quickly than normal. Check frequently for corroded areas and repair them promptly.

Connecting gas line to LPG Gas Cylinder

CAUTION: The gas governor, flexible rubber pipe and clamps are not supplied with this appliance and must be used proper ones, according to National Rules in force.

The gas governor has to be set for 28-30/37/50 mbar. Connect appliance pipe holder with proper flexible gas rubber pipe and fix it using proper clamps. If some gasket is needed, it must be according to Standard EN 549. If other material to guarantee tightness could be used, they must be in line with Standard EN 751 only.

Check the gas tightness with soap water each time you connect the pipe according to "**Leakage Test**".

Warning:

Change the LPG Gas Cylinder only in a well ventilated area, away from any inflammation source (candle, cigarettes, other flame producing appliances...).

Check that gas governor sealed and that it is in good condition.

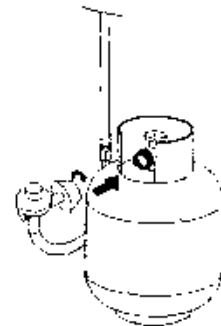

AREA HEATER ASSEMBLY

Tools Required

Phillips head screwdriver

2 adjustable spanners

Note: Remove any transit protection material

STEP 1

Attach wheel assembly to base with two M8X16mm bolt and nut..

STEP 2

Assemble the tank on the base with four M8 x 16mm and eight M5X10mm bolt and nut..

STEP 3

Put the burner on the tank, assemble the burner on the tank with four M4X8mm bolt and nut.

STEP 4

Put the mesh guard around the burner, the side with door should be face with the ignite. Fix the mesh guard in the hole on the tank with M4 nut.

STEP 5

Assemble the handle on the same side with wheel, use two M6 bolt and nut.

STEP 6

Screw the butterfly nut on the top of mesh guard.

OUTDOOR HEATER PARTS LIST

PARTS NAME	QUANTITY
WINNING NUT	1
MESH GUARD	1
NUT	4
BURNER	1
HANDLE	1
TANK HOUSING	1
HOSE and REGULATOR	1
M5X10MM BOLT and NUT	8
WHEEL	1
M8X16 BOLT	4
BASE	1
STEEL CONNECTOR	1

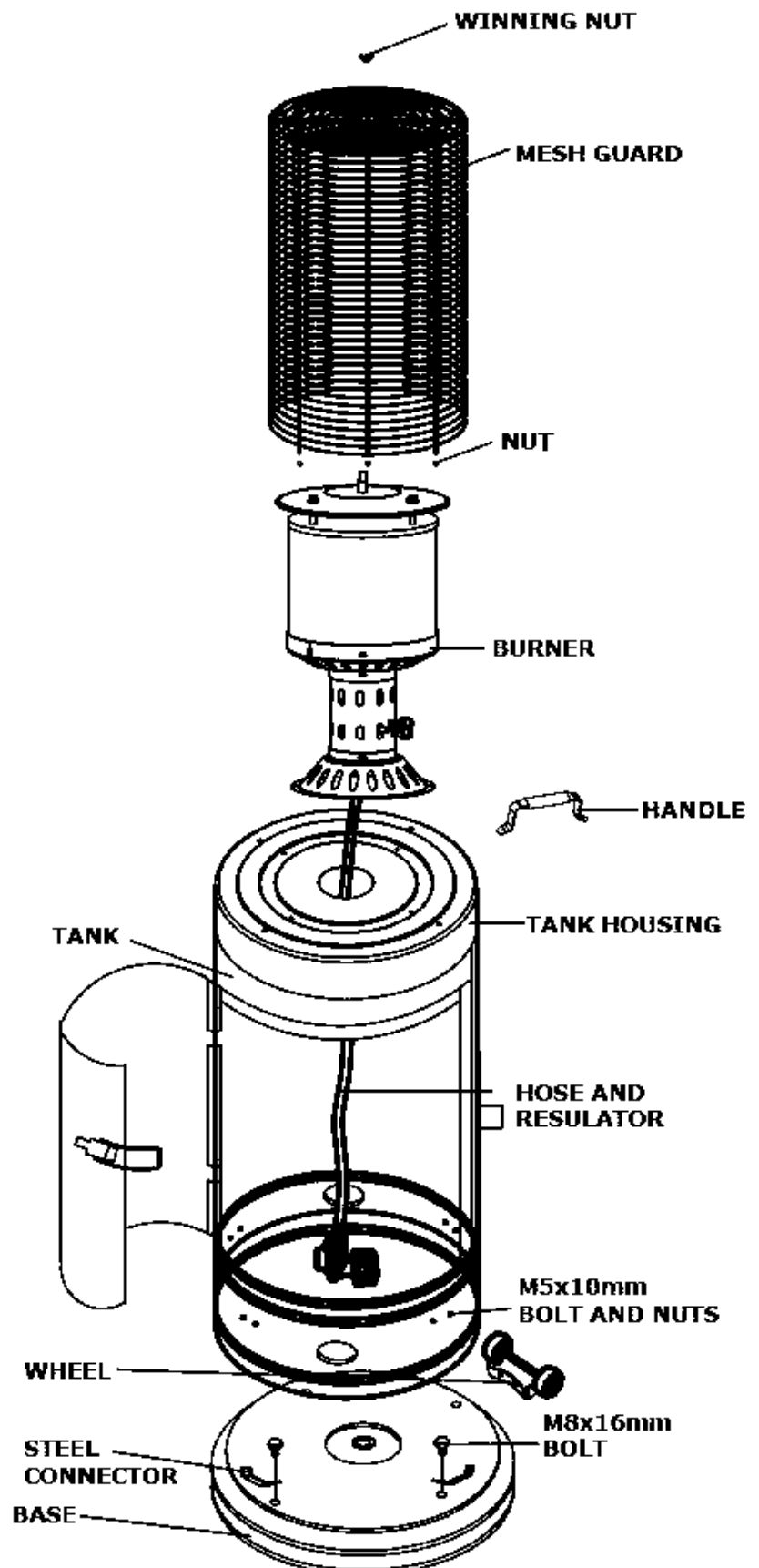

B - Specifications

- For outdoor use only.
- Uses propane, butane or mixture of them.

Models	Gas categories		Pressure (mbar)	Country/ies of destination	Qn (Hs)		Maximum consumption (g/h)
					Nominal Heat input	Reduced Heat input	
PH09-S PH09-S S	I3+	Gases (Propane Butane or their mixtures)	G30: 28-30 mbar G31: 37 mbar	<u>BE - CH - ES -</u> <u>FR - GB - GR - IE -</u> <u>IT - PT - LU - PL</u>	9.5kW 9.5kW	5kW 5kW	(G30) (G31)
	I3B/ P		G30/G31: 30 mbar	CY - CZ - DK - EE - FI - LT - LV - MT - NL - NO - SE - SI - SK - BG - RO - TR	9.5kW 9.5kW	5kW 5kW	(G30)
	I3P(50) I3B/ P(50)		G30/G31:5 0mbar	AT - DE	9.5kW	5kW	(G50)

C - Table of injectors

Gas Category	Usable gases	Gas Adjustment	Injector	By-pass	Pilot
I3+	<u>G30/G31</u>	28-30/37 mbar	1.9 (100/mm)	120 (100/mm)	18 (100/mm)
I3B/P		30/30 mbar			
I3B/P(50) I3P(50)		50/50mbar			

ASSEMBLY PARTS

Tools needed:

- Screwdriver wide/medium blade
- Spray bottle of soap solution for leakage test

Parts supplied:

- Open end wrench 10 & 12 mm
- Outer mesh guard
- Burner assembly
- 5pcs M4X10 bolts and 5pcs M4 screws
- Front panel
- Back panel
- 5pcs M8X16 bolts
- Base
- Wheels

PROBLEMS CHECK LIST

<u>PROBLEM</u>	<u>PROBABLE CAUSE</u>	<u>SOLUTION</u>
Burner will not light	<ul style="list-style-type: none"> • Burner injector clogged. • Low gas supply pressure. 	<ul style="list-style-type: none"> • Clean burner injector. • Call your gas supplier.
Burner flame goes off immediately after ignition	<ul style="list-style-type: none"> • Low gas pressure 	<ul style="list-style-type: none"> • Call your gas supplier.
Delayed ignition	<ul style="list-style-type: none"> • Main burner carry over ports clogged. • Low gas supply pressure 	<ul style="list-style-type: none"> • Clean main burner ports. • Call your gas supplier.
Inadequate combustion on burner	<ul style="list-style-type: none"> • Not enough air. 	<ul style="list-style-type: none"> • Check air passageways and burners for dirt and debris, and clean with compressed air.
Burner flame is low	<ul style="list-style-type: none"> • Supply hose is bent or twisted • Blockage in burner injector 	<ul style="list-style-type: none"> • Straighten hose and perform leak test on hose. • Clean or replace burner injector.
Emitter glows uneven	<ul style="list-style-type: none"> • Blockage in burner injector • Base is not on a level surface • Low gas pressure 	<ul style="list-style-type: none"> • Clean or replace burner injector. • Place heater on a level surface. • Replace cylinder with a new cylinder.
Slight smoke and odor during initial operation	<ul style="list-style-type: none"> • Residue from manufacturing processes. 	<ul style="list-style-type: none"> • Will stop after approx. 30 minutes of operation.
Thick black smoke	<ul style="list-style-type: none"> • Blockage in burner 	<ul style="list-style-type: none"> • Turn off the heater and let it cool. Remove blockage and clean burner inside and outside.
Heater produces a whistling noise when burner is lit.	<ul style="list-style-type: none"> • Air passageways blocked. • Air in the gas line. 	<ul style="list-style-type: none"> • Check minimum installation clearances and air passageways for debris. • Operate burner until the air is completely purged.
Heater produces a clicking noise just after burner is lit or turned off.	<ul style="list-style-type: none"> • Metal expanding and contracting, respectively. 	<ul style="list-style-type: none"> • This is common with heaters. If noise is excessive, contact a qualified person.
Gas odor even when control knob is in OFF position	<ul style="list-style-type: none"> • Gas leaks. • Gas control defective. 	<ul style="list-style-type: none"> • Locate and correct leaks immediately. • Replace gas control.

PROBLEM**PROBABLE CAUSE****SOLUTION**

Gas odor during combustion

- Foreign matter in gas or on burner ports.
- Heater burning vapors from paint, impurities in air.
- Gas leakage from:
 - Regulator and hose connection.
 - Valve and pipes connection.
 - Pipes

- Check gas passageway and burner.
- Stop storing and using odor-causing products near the heater.
- Locate and correct leaks, or contact your gas supplier.

Carbon build-up

- Dirt or film on reflector and flame screen

- Clean reflector and flame screen.