

COLORATO

www.colorato.net

INSTRUCTION MANUAL OF COMMERCIAL BLENDER



MODEL: CLB-1800S

Read carefully these instructions before using the appliance and
save them for future reference

Contents

COLORATO recommends safety first	2
Important safeguards for your blender	2
Important safeguards for all electrical appliances.....	3
Know your blender.....	4
Exploded view of Spare Parts.....	5
Operating your blender.....	6
Technical Parameters.....	7
Disassembling your blender for cleaning, care and storage.....	8
Tips on how to use your blender.....	9
Suggested uses for your blender.....	10
Recipes.....	10
Trouble shooting chart.....	11
Guarantee of product's good operation.....	12

COLORATO recommends safety first

We at COLORATO are very safety conscious. We design and manufacture consumer products with the safety of you, our valued customer foremost in mind. In addition, we ask that you exercise a degree of care when using any electrical appliance and adhere to the following precautions:

Important safeguards for your blender

- ◆ Carefully read all instructions before operation and save for future reference.
- ◆ Remove any packaging material and promotional stickers before using the blender for the first time.
- ◆ Do not place the blender near the edge of a bench or table during operation. Ensure that surface is level, clean and free of water, flour etc. Vibration during operation may cause the appliance to move.
- ◆ Do not place this appliance on or near a hot gas or electric burner, or where it could touch a heated oven.
- ◆ Always ensure the blender is properly assembled before use. Refer to assembly and operation (page 6).
- ◆ Use only the blender jug and lid supplied with the blender.
- ◆ Always ensure the blender lid is firmly positioned on the blender jug before operating.
- ◆ Do not leave the blender unattended when in use.
- ◆ Ensure that the switch in the control panel is in OFF position and then unplug from the power outlet before attaching the blender or attempting to move the appliance, or when the blender is not in use and before cleaning and storing.
- ◆ Do not operate the appliance continuously for more than 3 minutes. After the 3 minutes, stop for one minute before you continue.
- ◆ Never place your fingers or utensils inside the blender without unplugging the unit from the power outlet.
- ◆ Be careful when handling the blending blade as the blade is very sharp. Mis-handling of the blade may cause injury.
- ◆ Keep hands, hair, clothing, as well as spatulas and other utensils away from the blender jug during operation.
- ◆ Do not remove blender jug from the motor base whilst in operation. Remove the jug only when the appliance is completely off.
- ◆ To protect against electric shock do not immerse the motor base, plug or cord in water or any other liquid.
- ◆ Do not use the blender for anything other than food and/or beverage preparation.
- ◆ Do not process boiling liquids; allow to cool before placing into the blender jug. Make sure the motor and blade have completely stopped, the POWER switch is pressed down and it is unplugged from the power outlet before disassembling.
- ◆ Keep the appliance clean. Refer to care and cleaning (page 8).

Important safeguards for all electrical appliances

- ◆ Fully unwind the cord before use.
- ◆ To protect against electric shock, do not immerse cord, plug or motor base in water or any other liquid.
- ◆ Do not let the cord hang over the edge of a table or counter, touch hot surfaces or become knotted.
- ◆ This appliance is not intended for use by young children or infirm persons unless they have been adequately supervised by a responsible person to ensure they can use the appliance safely.
- ◆ Young children should be supervised to ensure that they do not play with the appliance.
- ◆ It is recommended to regularly inspect the appliance. Do not use the appliance if the power supply cord, plug or appliance becomes damaged in any way. Return the entire appliance to the nearest authorized COLORATO Service Centre for examination and / or repair.
- ◆ Any maintenance other than cleaning should be performed at a COLORATO authorized Service Centre.
- ◆ This appliance is for professional use. Do not use this appliance for anything other than its intended use. Do not use in moving vehicles or boats. Do not use outdoors.

CE  ROHS

The symbol  on the product means that at the end of its life, the appliance has not to be considered a common waste. It is a special waste and has to be demolished in specific recovery and disposal area, as prescribed by the EC Directive 2002/96/EC(WEEE). By disposing this product correctly, you can avoid negative consequences for the environment and for the human health, due to the presence of potentially dangerous substances in the product.

Attention

Know your Blender



Exploded view of Spare Parts

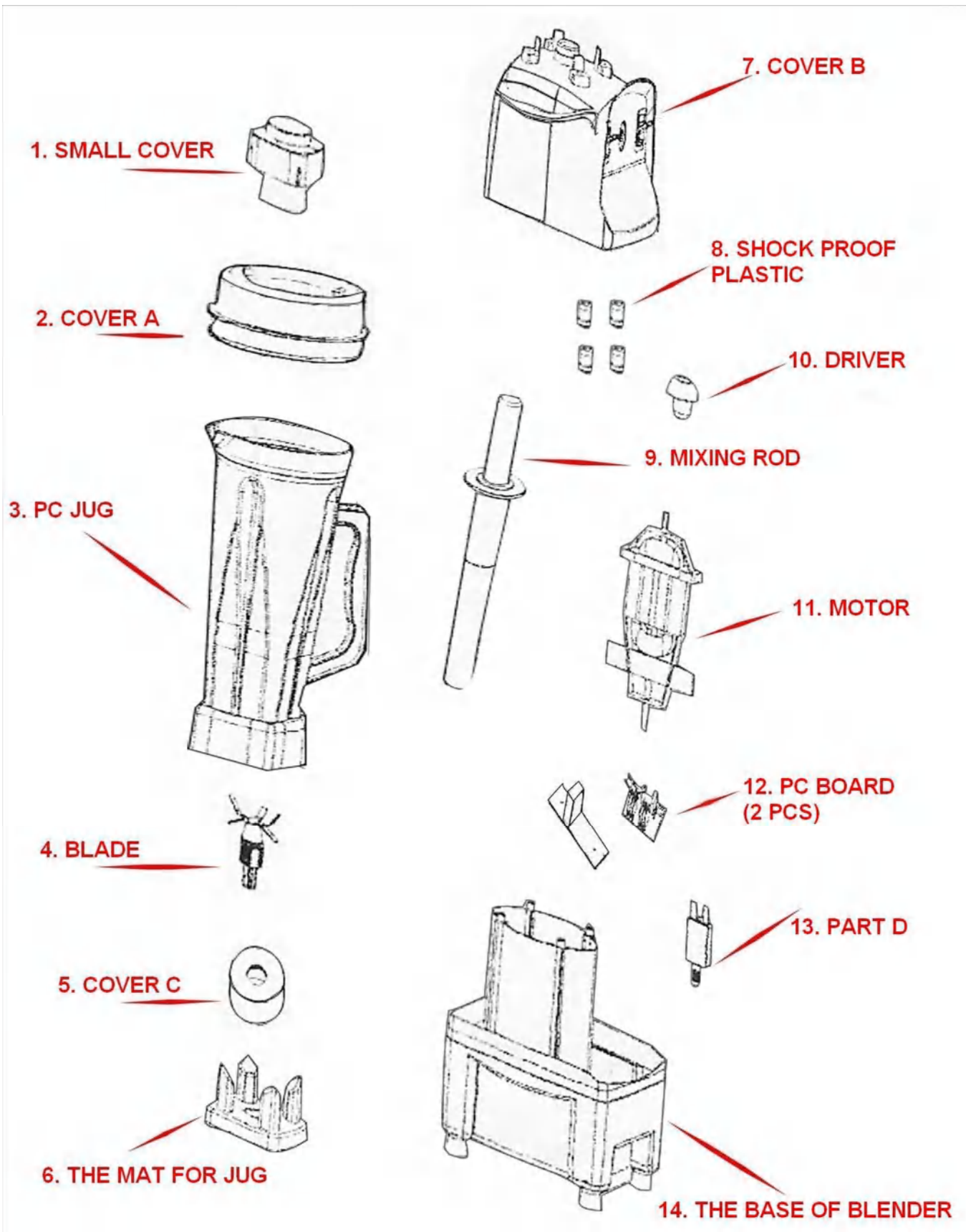

Operating your Blender

Before first use

Before using your blender for the first time, remove any packaging material and promotional labels. Ensure the appliance is switched off and the power cord is unplugged from the power outlet. Wash the lid, blender jug, mixing rod and blade assembly of the blender in warm soapy water, with a soft cloth. Rinse and dry thoroughly. Do not place parts in the dishwasher. The motor base can be wiped with a damp cloth to remove any dirt. Dry thoroughly.

When first using the Blender, you may notice an odour coming from the motor. This is normal and will dissipate with use.

All processing blades are extremely sharp. Avoid any contact with hands.

Note

Assembling and attaching the blender

1. Place the motor base on a flat, dry surface such as a bench top. Ensure that the motor is switched off and the power cord is unplugged from the power outlet.
2. Turn the blender jug upright and insert on to the motor base.
3. Add food or liquid into the blender jug. Place the blender lid firmly into position on the top of the blender jug.
4. Plug the power cord into a 230 / 240 V power outlet and either lift the Switch of Continuous Operation (POWER), or press down the Switch of Pulse Operation (PULSE). Always use one of the two switches and never both of them together.

5. Select the required speed function by choosing either the Pulse operation by pressing down the PULSE switch, either the Continuous Operation, by lifting the POWER switch. Speed can be changed at any time during the blending process by adjusting the Variable Speed Regulator from the MINIMUM to the MAXIMUM. Press down the POWER switch or let the PULSE switch to stop blending.
6. For ingredients that require short bursts of power, use the switch of the PULSE function. Press the PULSE switch down for short bursts until blending is complete.
7. The ice crush requires the highest speed and is performed with the Pulse Operation switch.
8. At the end of use, press down the POWER switch or let the PULSE switch and unplug the power cord from the power outlet.

Important- To crush ice

Place 1 cup of frozen ice cubes into the Blender jug. Replace lid and press the PULSE switch down. Once a snowy textured ice is achieved, let the switch in order to stop the ice crushing. This will take approximately 15 seconds.

During the blending process, ingredients may stick to the sides of the Blender jug. To push the food back onto the blades, press the POWER switch down and unplug the power cord from the power outlet. Remove the lid and use a plastic spatula to scrape down the sides of the jug. Replace the lid before recommencing blending.

If any moisture of liquid appears on top of the motor base, press the POWER switch down and unplug the power cord from the power outlet. Remove the blender jug. Wipe the motor base immediately with paper toweling and check the blender jug is correctly assembled.

Note

NEVER PLACE ANYTHING OTHER THAN FOODS AND LIQUIDS IN THE BLENDER WHILST THE MOTOR IS RUNNING.

Technical Parameters

Model	CLB-1800S
Voltage	220-240V~50 Hz
Capacity of the Jug	2 L
Endurance of the Jug	-40°C~99 °C
Power of the Motor	1800 W
Net Weight	4.5 kg
Blades	2.0 mm, #304 stainless steel
Length of cord	1.7 M
Dimensions	190 x 220 x 480 mm (WxDxH)
Protector	Current protector, Thermal protector for Motor
Rounds of the motor/ r.p.m.	Minimum 11000 ~ maximum 28000

* The appliance with 220V is available in 10A plug.

Disassembling your blender for cleaning, care and storage

Cleaning after use

1. Always ensure the blender is OFF by pressing the POWER switch down or letting the PULSE switch and unplugging the power cord from the power outlet.
2. Remove the blender jug from the motor base by grasping the handle and lifting the jug in an upward direction.

Cleaning the motor base

1. Wipe the motor base with a soft, damp cloth, and then dry thoroughly.
2. Wipe any excess food particles from the power cord.

Cleaning the blender jug, inner lid and lid

- ◆ Wash all parts in warm soapy water and dry with a soft cloth. Use a kitchen bottle brush to dislodge stubborn foods. Rinse and dry thoroughly.

Do not use abrasive scouring pads or cleaners when cleaning the parts of motor base as they may scratch the surface.

Note

Removing stubborn or strong food stains and odours

Strong smelling foods such as garlic, fish and some vegetables such as carrots may leave an odour or stain on the blender jug and lid. To remove, soak blender jug and lid for 5 minutes in 100 ml bleach dissolved in 2 litres water. Then wash with a mild detergent and warm water, rinse well and dry thoroughly.

Storage

Store the Blender on the top of the workbench. The blender jug and lids can be assembled and stored on top of the motor base or next to it.

The chopping blade is extremely sharp!! Use caution when handling and storing these parts.

Note

Tips on how to use your Blender

Do

- Use the switch of Continuous Operation at the low speeds of the Variable Speed Regulator for emulsions such as mayonnaise, dressings, marinades and foods that require mixing until just combined, such as batters.
- Use the switch of Continuous Operation at the high speeds for pureeing, drink or cocktail making.
- Use the switch of the Pulse operation for foods that only require short bursts of power such as chopping nuts.
- Use the PULSE switch for ice crushing.
- Ensure all parts have been thoroughly washed, rinsed and dried before assembly.
- Ensure the Blender is correctly assembled before operating.
- Ensure the base of the blender jug is thoroughly dry before placing onto the motor base.
- Ensure the Blender is placed on a clean, dry and level surface to operate.
- Ensure liquid ingredients are placed into the blender before solid ingredients, except where specified in recipes.
- Ensure all foods are cut into cubes (approx. 2-3 cm squares) where appropriate to achieve an even result.
- Use a plastic or rubber spatula to dislodge food from sides of the jug. Always ensure that the blender is turned off by pressing the POWER switch down and unplugging the power cord from the power outlet. Ensure blades have stopped rotating. Do not use metal utensils as they may damage the blades or blender jug.

Don't

- For normal blending tasks, for example, mayonnaise, dressings etc., do not operate for longer than 1 minute at one time without turning off the blender and stirring the ingredients, and then continue blending.
- Do not operate the blender at the high speed for more than 3 minutes. Stop blending for 1 minute before you continue.
- Do not operate the blender without having the blender lid in position. To add additional ingredients whilst blending remove the inner lid and place ingredients through the opening in the middle of the lid.
- Do not place any objects, other than food, into the blender whilst the motor is running.
- Do not use blender jug to store food.
- The blender does not circulate air when blending; therefore it will not beat egg whites, knead dough or mash potatoes.
- Do not remove the blender jug while the blender is operating. Always make sure the blender is off, by pressing the POWER switch down or letting the PULSE switch and unplugging the power cord from the power outlet.
- Do not overload the blender with more than the specified quantity of ingredients as doing so could cause the motor to stall. Turn the blender off, by pressing the POWER switch down and letting the PULSE switch and unplug the power cord from the power outlet. Remove a portion of the mixture from the blender jug before continuing.
- Do not place hot ingredients into the blender; allow to cool before placing into the blender jug.

Suggested uses for your blender

Crush Ice

Place 1 cup of frozen ice cubes into blender jug only and blend using the switch of Pulse Operation for 15 seconds.

Drinks

Fill the container to at least $\frac{1}{4}$; remember to leave room to allow froth to form as the drink is aerated.

Soups, sauces, purees

The most efficient amount to blend will depend on the food / recipe used. Generally, the more liquid used, the more can be processed at one time. Do not place hot ingredients into the blender; Allow to cool before pureeing.

Quantities and handy hints

- Do not put more than 2 cups of warm ingredients into the blender before handling commences. After the blending process has begun and the blades are turning you may slowly add another $1\frac{1}{2}$ cups of ingredients through the opening in the lid if desired.
- Thick mixtures puree more efficiently if the blender is $\frac{1}{4}$ to $\frac{1}{2}$ full.
- When using several ingredients, place liquid ingredients in the blender jug first unless specified in the recipe.
- When blending thick or dry mixtures it may be necessary to stop the blender and scrape down the sides of the blender jug with a plastic or rubber spatula, once or twice during blending. Cut all food pieces into 2 cm cubes where appropriate.

Recipes

Margarita

60 ml Tequila
60 ml Cointreau
80 ml lime juice
12 ice cubes

1. Place Tequila, Cointreau, lime juice and ice cubes into blender jug.
2. Set at the Max Speed and blend until well combined and ice is crushed.

Serve in salt rimmed glasses.

Rockmelon and pineapple frappé

1 cup chopped rockmelon
1 cup canned pineapple pieces
1 cup ice
Mint leaves, to serve

1. Place rockmelon, pineapple and ice into the blender jug.
2. Set at the max Speed and blend until all ingredients are crushed and mixture is smooth and thick.
3. Serve with chopped mint leaves.

Strawberry Smoothie

150 g strawberries
250 ml milk
2 scoops vanilla ice cream
Strawberry topping, to serve

1. Place strawberries, milk and ice cream into the blender jug.
 2. Set at the Max Speed and blend until smooth and combined.
- Serve with strawberry topping drizzled over top.

Troubleshooting chart

Follow these steps if the unit fails to operate:

1. Check instructions have been follow closely and correctly
2. Check “Troubleshooting Guide” for possible solutions
3. Check fuse has been blown.

Problem	Solution
Motor doesn't start or blade doesn't rotate	<ul style="list-style-type: none"> • Check that the blender jug and lid are securely locked into position • Check that the power plug is securely inserted into the power outlet • Be sure to press only one function control button at a time
Food is unevenly chopped	Either too much food is being chopped at one time or the pieces are not small enough. Try cutting food into smaller pieces of even size and processing a smaller amount per batch. For best results the food should be chopped into pieces no larger than 2 cm.
Food is chopped too fine or is watery	The food is over processed. Use brief pulses or process for a shorter time.
Food sticks to blade	Processing too much food. Turn the blender off. When the blade stops rotating, remove the blender lid and remove some food with a spatula.
Higher than normal levels of vibration and container noise	Check blade assembly for loose, damaged or nicked components and replace.
Leaking from the bottom of the container	
The appliance is not working	<ul style="list-style-type: none"> • Double-check to make sure power cord is firm plugged into the power outlet. • Check to make sure switches are clean and moving freely • The thermal protector may have shut the machine off. Leave power off for up to 45 minutes. Try circulating air with a fan at the bottom of the motor base.
Loud noise from blade area	Drive socket may be broken. Check for a fine crack down the center or worn teeth.

In case you cannot make the appliance work after the above suggestions, contact your supplier to inform you for the service center.

